

Quick Set Hose Clamp

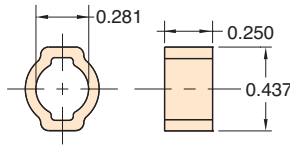

Type: Zinc plated steel
Use: 5000-1 with twin vinyl hose



Part No. **Description**
5000-1 Hose Clamp

Quick Set Hose Clamp



Type: Zinc plated steel

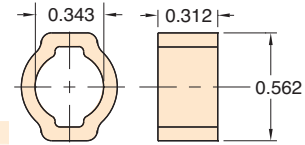

Part No. **Description**
5000-1A Hose Clamp

Reusable Hose Clamp

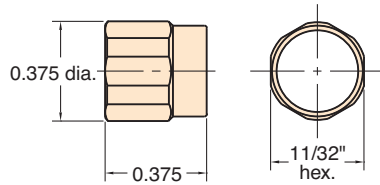

Part No. **Description**
5000-2 Hose Clamp

Material: Brass, self-threading, reusable

Use With: 11765 Buna-N hose VYH1-0804-CLT vinyl hose and Clippard hose fittings

Installation: Slip sleeve over hose, push onto fitting, then screw into place; tighten with wrench

Options: (-ENP)



Press-On Hose Clamp

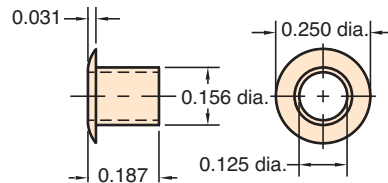

Part No. **Description**
5000-4 Hose Clamp

Material: Brass, press-on hose clamp

Use: for VYH1-0402-CLT hose 1/16" I.D. vinyl

Installation: Simply place hose clamp over hose with flange end out; then press hose partially onto fitting, then slide clamp back toward fitting to secure

Options: (-ENP)



Polyethylene vs Vinyl vs. Polyurethane

Polyurethane offers a wider range of chemical compatibility than Vinyl, it may be used at much higher temperatures and clamps are not needed when used with barb fittings. Linear low density polyethylene offers a lower cost alternative to polyurethane and superior environmental stress crack resistance over standard polyethylene. Both polyurethane and polyethylene are FDA approved.

Typical Hose & Tubing Bend Radii

When using hose or tubing, care should always be taken to avoid sharp bends to prevent compressing the inside diameter of the hose or tubing and restricting flow. For extremely close connections, allow a short loop of hose to avoid crimping.

| Clippard Hose & Tubing | | I.D. | O.D. | Min. Bend Radius |
|------------------------|-------------------------------|--------|-------|------------------|
| 3811-1-RL | Copper Tube | 1/16" | 1/8" | 3/8" |
| NYT1-XXX | Nylon Tubing | 3/32" | 1/8" | 3/8" |
| VYH1-XXX | 80A Duro. Vinyl Hose | 1/16" | 1/8" | 3/8" |
| VYH1-XXX | 80A Duro. Vinyl Hose | 1/8" | 1/4" | 1/2" |
| VYH2-XXX | Dual Vinyl Hose | 1/8" | 1/4" | 1/2" |
| URH1-XXX | 85A Duro. Polyurethane Hose | 1/16" | 1/8" | 3/16" |
| URH8-XXX | Ribbon 85A Duro. Polyurethane | 1/16" | 1/8" | 3/16" |
| URH1-XXX | 85A Duro. Polyurethane Hose | 1/8" | 1/4" | 3/8" |
| URH2-XXX | Dual 85A Duro. Polyurethane | 1/8" | 1/4" | 3/8" |
| URH8-0804-XXX | Ribbon 85A Duro. Polyurethane | 1/8" | 1/4" | 3/8" |
| URT1-0503-XXX | 95A Duro. Polyurethane Tubing | 3/32" | 5/32" | 3/8" |
| URT1-0604M-XXX | 95A Duro. Polyurethane Tubing | 4 mm | 6 mm | 1/2" |
| URT1-0805-XXX | 95A Duro. Polyurethane Tubing | 0.160" | 1/4" | 1/2" |
| URT1-0805M-CLT | 95A Duro. Polyurethane Tubing | 5 mm | 8 mm | 3/4" |
| URT1-1208-XXX | 95A Duro. Polyurethane Tubing | 0.245" | 3/8" | 7/8" |
| URT1-1610-XXX | 95A Duro. Polyurethane Tubing | 0.320" | 1/2" | 1 1/8" |
| PET1-0503-XXX | 50D Duro. Polyethylene Tubing | 0.106" | 5/32" | 1/2" |
| PET1-0604M-XXX | 50D Duro. Polyethylene Tubing | 4 mm | 6 mm | 1 1/4" |
| PET1-0805-XXX | 50D Duro. Polyethylene Tubing | 0.170" | 1/4" | 1 1/4" |
| PET1-1208-XXX | 50D Duro. Polyethylene Tubing | 1/4" | 3/8" | 2" |